

# High Performance Honing Machines



E Series



Speedhone



Powerhone

Delivering Honing Excellence

In Technical Collaboration with



## Vertical Honing Machines - Powerhone

These machines are equipped with automatic feed, for large and heavy components in small / medium sized batches and prototypes. They are suitable for both through and blind bores while ensuring excellent stock removal rates. These compact machines are designed for durability, efficiency and economical honing.

Powerhone features an integrated work table along with an easily removable 60 liter honing fluid tank, with magnet and cartridge filtering system. A flexible component clamping system and ease of access ensure swift production changeover for operational efficiency.

The user friendly controller features a digital cycle timer and includes control of the feed unit.

### Features:

- Fully adjustable spindle and stroking speeds
- Accurate and repeatable stroking movement
- Hydraulic stroking motor
- Bore diameter range of 25.4 to 900 mm, subject to honing application
- Short stroking at any position
- Integrated worktable
- Automatic feed system supplied as standard

### Specifications

Capacity and stroke		
Diameter range	mm	25.4 – 900*
Stroke length, fully adjustable	mm	1000
Stroking motor speed fully adjustable	m/min	20
Stroking motor power	kW	1.5 at 40 bar
Spindle drive		
Spindle speed, fully adjustable	rpm	40 – 250
Spindle motor power	kW	1.5
Feeding system		
Standard		Automatic
Option		Manually operated friction feed system
Installation data		
Weight – Net/Gross	kg	900/1000
Dimensions – W x D x H	mm	1430 x 2750x1900

\*Subject to honing application



### Machining length - Diameter dependent

Diameter	Honing length
25.4mm	400mm
31.8mm	520mm
38.1mm	604mm
44.5mm	660mm
50.8mm	750mm
57.1mm	812mm
68.0mm	820mm

### Dimension Details

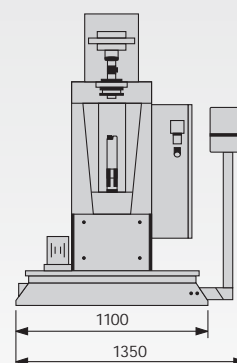
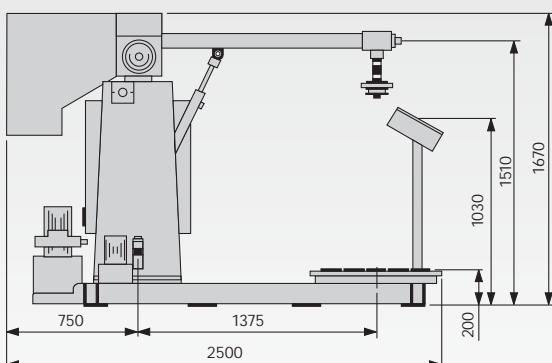

## Horizontal Honing Machines - E 1000 & E 2000 Series

These machines are ideal for small to medium size batches. Their numerical control system delivers precise, efficient and repeatable honing process for a wide range of components.

With a diameter range from 1.14mm to 120mm and stroke lengths of 3mm to 320mm, these machines provide versatile honing solutions for a wide variety of applications.

Consistent honing and exact cycle times are pre-programmed through user-friendly touch pad numeric control, to deliver controlled precision cutting and extended tool life. The controller has the capacity for 100 pre-programmed processes. It also incorporates a teach function, for the fast set-up of stroke position and short stroking.

Machine stability is ensured by rigid module plate design, providing repeatability of stroke and size, for accurate bore geometry across a wide range of applications.



### Features:

- Fully adjustable spindle and stroking speeds
- Automatic start cycle procedure
- Choice of NC controllers and user friendly touch pad numeric control panel
- Rigid tray design
- Fail safe interlocking door with electric sensor for operator safety
- Easily removable, integral, three stage fluid filter unit
- Ergonomic work station for operator comfort and efficiency
- Low voltage work lamp
- Manual operations for small batches and prototypes

### Specifications

	Unit	E1000	E2000A E2000B
<b>Capacity &amp; stroke</b>			
Diameter range	mm	1.14 – 25*	1.14 – 120*
Stroke length, fully adjustable	mm	0 – 300*	3 – 320*
Stroking motor speed - Fully adjustable	m/min	1 – 25	1 – 25
Stroking motor power	kW	0.92	2.2
Stroking movement		Precision recirculation ball screw	
Short stroking		Fully programmable length and frequency	
<b>Spindle drive</b>			
Spindle speed, fully adjustable	rpm	200 – 2500	150 – 3500
Spindle motor power	kW	1.5	3
Braking		DC electronic induction braking	
<b>Feeding system</b>			
Feed type		Electromechanical	Programmable
Feed rate		Programmable	
Feed force		Programmable to 1000N	
Wedge retraction		Programmable	
<b>Installation</b>			
Weight Net/Gross	kg	600/700	720/1000
Dimensions - W	mm	1930	1400
D	mm	1005	2180
H	mm	1800	1980

\*Subject to honing application

### Choice of Control Panels

	E 2000A	E 2000B
No of Feed rates + timer	2	3
Stroke speed change options	No	Yes
Speed change options	1	2
Stroke/rotation start/stop position	No	Yes
Encoder datum	Required	Automatic

### Dimension Details

E 1000

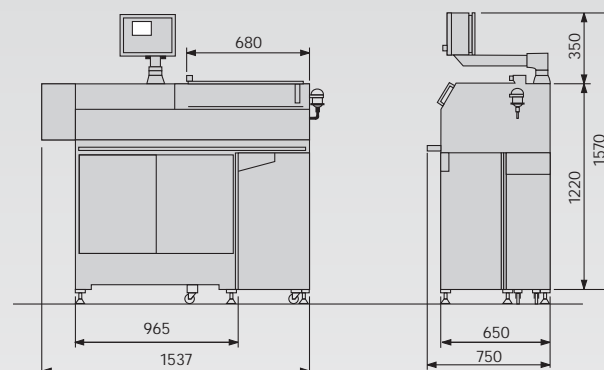

E 2000A & E 2000B

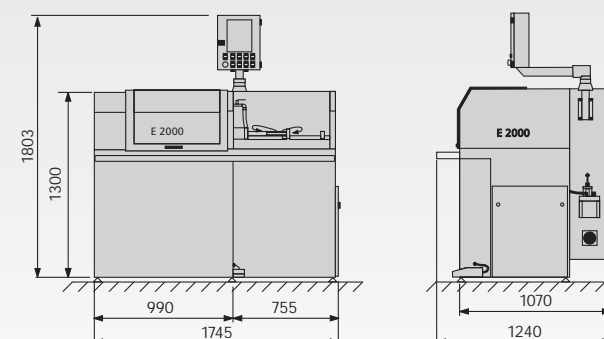

The automated version of these horizontal honing machines ensures high volume, batch production and applications where high stock removal rates are required. The manual version is ideal for small batch production and prototypes.

Fully adjustable spindle speeds, stroking speeds and stone pressures facilitate the smallest mandrel or the greatest rate of stock removal.

The 'stone saver' feature of the automated version(EA) allows operators to override stone expansion speed, using the foot pedal to control expansion and make optimum use of the honing stone.



EM (Manual Version)

EA (Automated Version)

## Features:

- Available as manual or automated models
- Bore diameter range of 1.14 to 80mm, subject to honing application
- Built in dial indicator for feed expansion comparison
- Rigid tray design
- Push button control panel
- Adjustable chuck as standard
- Form for operator comfort and efficiency
- Easily removable, integral, three stage fluid filter unit
- Ergonomic work platform for operator comfort and efficiency
- Low voltage work lamp as standard
- Wide range of additional standard features for the automated version(EA)

	Speedhone – EM	Speedhone – EA
Diameter range	1.143 -79.375mm. Other sizes to special order	
Spindle speed	Fully variable: 200 – 2500 rpm	
Rotation motor	1.5kW	
Stroke length fully adjustable:	N/a	0 -155mm
Reciprocation speed	N/a	0.37kW
Stone feed	N/a	Operator controlled via the foot pedal, with fine manual adjustable & dial indicator reading
Stone pressure	Fully variable within two ranges, light or heavy. Pre-set or adjustable during cycle	
Honing fluid	75L T.E.F.C. motorized pump 0.12kW	
Work lamp	25V lamp, adjustable arm	
Size control	Dial indicator	Auto size cut-off, with micro switch & metric dial indicator. In-process timer: range 0-10 mins. Other ranges available. Single or multi-stone plug sizing
Dimensions	1210x1210x1680mm	1620x1210x1680mm
Weight – net/gross	225/362 kg	298/478 kg

## Dimension Details

EM (Manual Version)

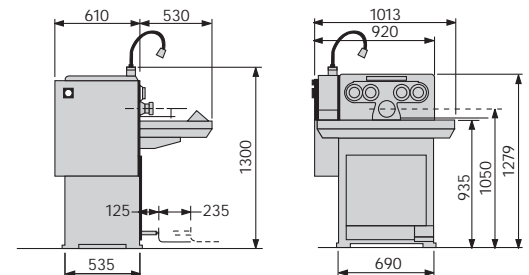

EA (Automated Version)

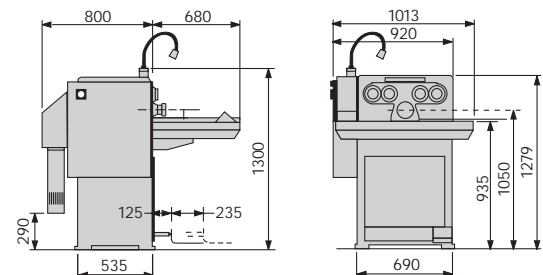

Since continuous improvements are made, specifications are subject to change without notice.

## WENDT (INDIA) LTD.

# 69/70, Sipcot Industrial Complex, Hosur-635 126, Tamil Nadu.  
 Ph: +91-4344-276851, 276852, 276254, 405500, 405501.  
 Fax: +91-4344-405620, E-mail: wil@wendtindia.com Web: www.wendtgroup.com

### Regional Offices:

BANGALORE ● BARODA ● CHENNAI ● COIMBATORE ● DELHI ● FARIDABAD ● HYDERABAD ● HOSUR  
 ● JAMSHEDPUR ● KOLKATA ● MUMBAI ● NAGPUR ● NASHIK ● PUNE ● RUDRAPUR

For more information contact:  
 E-mail: sajuabraham@wendtindia.com  
 venkateshms@wendtindia.com